

## BOTTOM LOADING COUPLER F228



### F228 Bottom loading coupler

The Whittaker four-inch bottom loading coupler is designed in accordance with API RP1004.

#### NOTES:

1. Modification A, K & N may be added to the basic F228 and all other modifications
2. Modification C may be used in conjunction with all other modifications
3. Modifications D, F, & G are separate modifications and cannot be combined with each other
4. See back page for dimension of basic style coupler

#### Features

- Push-on, pull-off, one-hand operation no rotation-no slots
- Fully interlocked - can't be opened unless locked and can't be removed unless closed
- Minimum disconnect spillage with dual seals within API specs
- Floating nose seal provides positive seal under operating conditions
- Dust protection sleeve seal
- Full flow four-inch design - 4.7 PSI pressure drop thru F228/F433 at 1000 gpm
- Lightweight design - 13.6 pounds
- Four-inch NTT flanged inlet standard, other options available as listed below
- Mates adapters made to API PR1004 (See catalog page on API adapters)
- Standard seals recommended for all commercial automotive and aircraft fuels, Viton seals available
- Whittaker four-inch swivels available as modifications
- Operating pressure - 120 PSI maximum, 350 PSI peak surge

For modifications see modification Page M228.

See the modification section of this catalog for various options to the part number listed above.

Contact your local Whittaker distributor or Whittaker directly for technical information beyond that listed in the technical section of this catalog.

# BOTTOM LOADING COUPLER

## F228

### F228 Dimensions

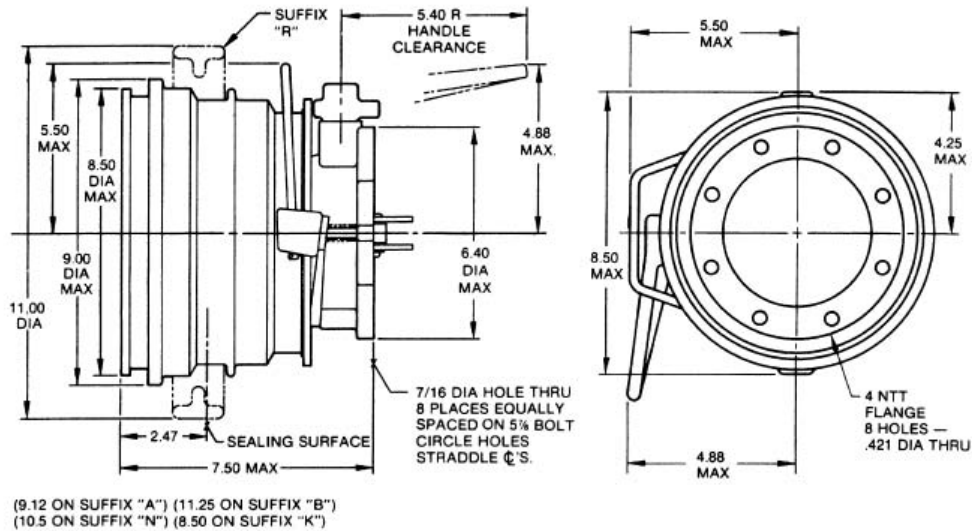

**Avery-Hardoll**  
 Holland Way  
 Blandford Forum  
 Dorset DT11 7BJ  
 UK

Tel: +44 (0) 1258 486600  
 Fax: +44 (0) 1258 486601

[www.meggittfuelling.com](http://www.meggittfuelling.com)

**Whittaker Controls**  
 12838 Saticoy St  
 North Hollywood  
 California 91605-3505  
 USA

Telephone: +1 818 765 8160  
 FAX: + 1818 759 2194

[www.wkr.com](http://www.wkr.com)  
[www.meggitt.com](http://www.meggitt.com)

**Aljac Fuelling Components Ltd**  
 Unit 2, 14 Brooklands Close  
 Sunbury on Thames  
 Middlesex TW16 7DX  
 UK

Tel: +44 (0) 1932 779588  
 Fax: +44 (0) 1932 779599

[www.aljac.com](http://www.aljac.com)



**MEGGITT**